

## Side Mounting Float Switch

MICRO SWITCH MODEL (REED SWITCH ON REQUEST)

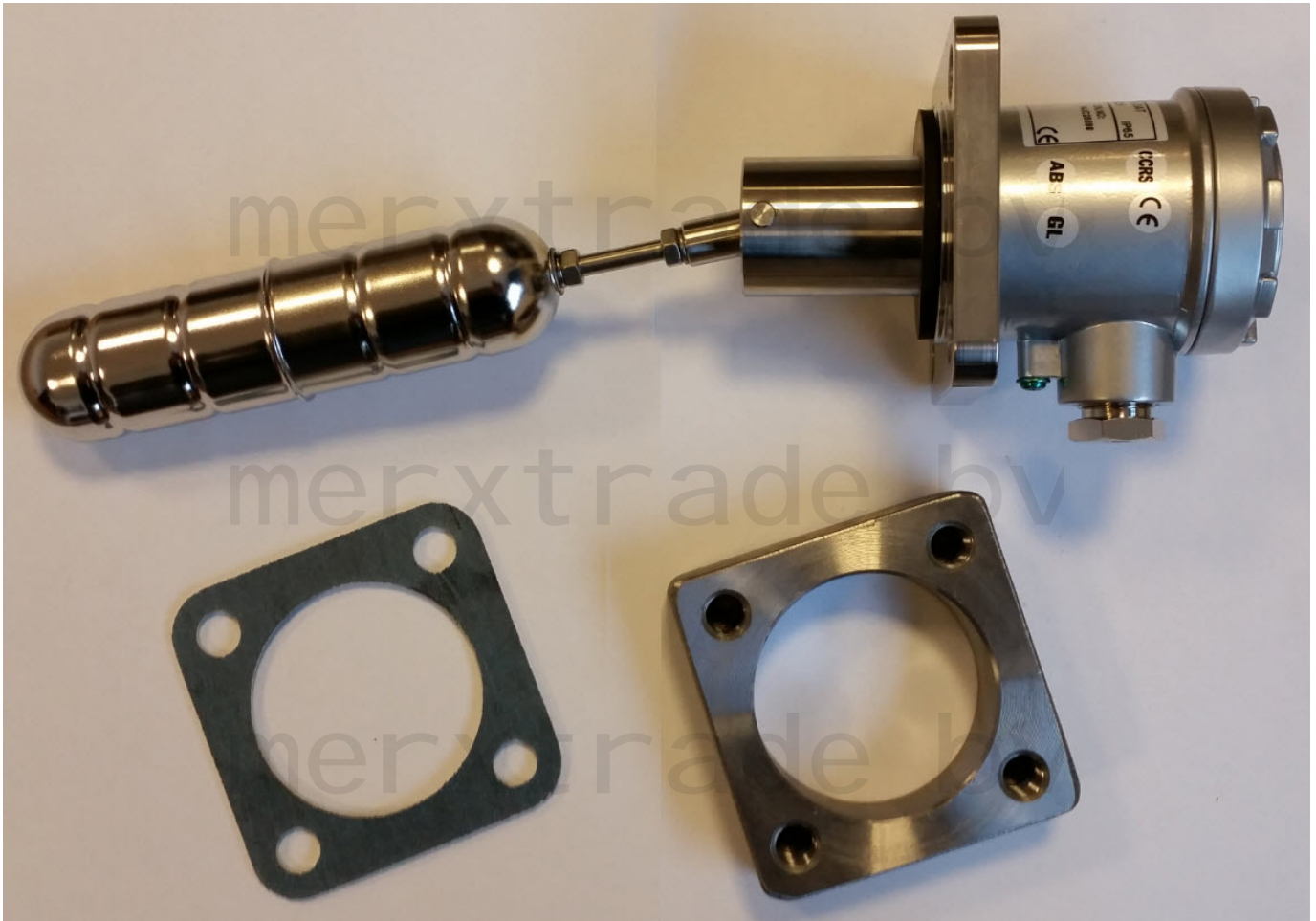

Optional: welding flange and gasket

The level switch MXT-8336CLO is interchangeable with other brand level switches

# INTRODUCTION

## WORKING PRINCIPLE

The reed switch relies on two basic scientific principles namely: buoyancy and magnetism.

Buoyancy causes the float (which contains a magnet) to rise with the liquid and magnetism helps open and close the switch.

A change in liquid levels raises or lowers the float up or down. The end of the pivot arm (non float side) contains a permanent magnet that can repel the switch magnet (inside the stationary 'stem' of the entire structure).

When the float magnet moves close to the switch's stationary stem, the float magnet repel the switch magnet which either opens or closes the Electrical circuit.

## FEATURES

The side mounted float level sensor are manufactured specifically for horizontal mounting on tanks or vessels. They work well as high or low level controls.

1. Both Micro-Switch types and Reed Switches are available. The MicroSwitch type is usable even at ambient temperatures of 100° C maximum.
2. Mounting flanges are custom-made. (JIS, DIN,ANSI).
3. A wide variety of floats for different solution's specific gravities (S.G.) are available.
4. Wetted parts material ranges from plastics, stainless steel, anti-corrosive and explosion proof types.

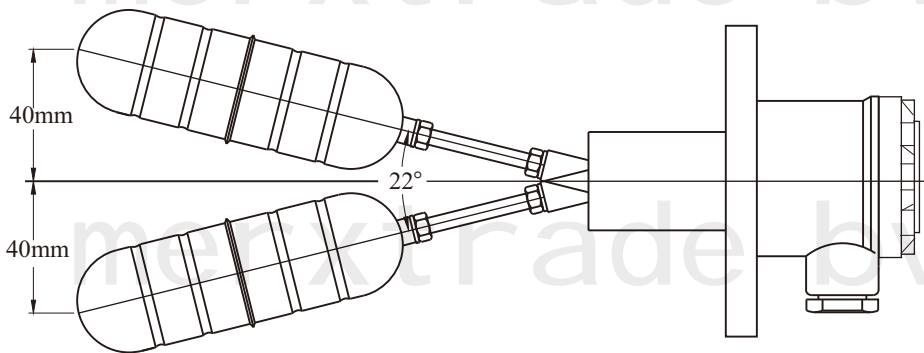

## WIRING

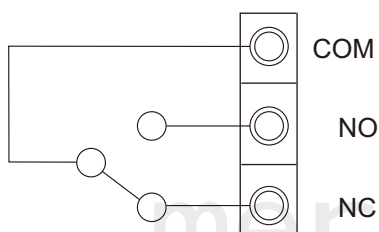

REED SWITCH ---- 1A, 30W 220Vac/200Vdc (FF20, 45, 55, 8□ )  
MICRO SWITCH ---- 5A/250Vac

# CONFIGURATION DIAGRAMS

## Reed Switch type (option)

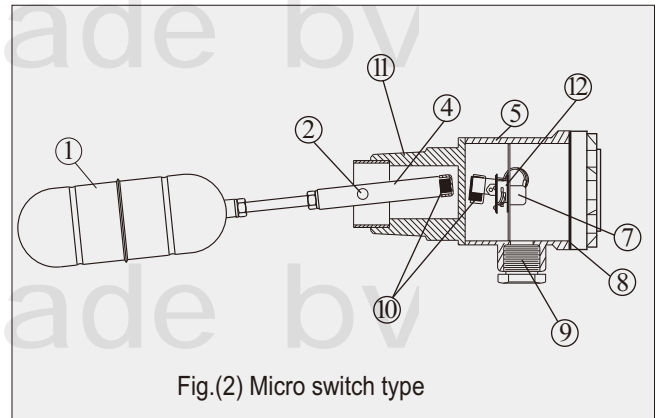
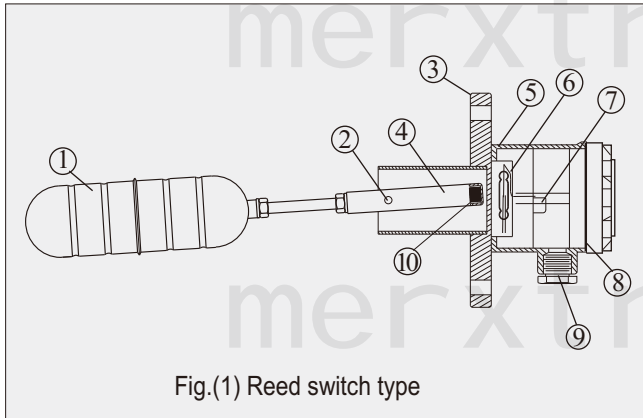

- |           |                |                                  |                 |
|-----------|----------------|----------------------------------|-----------------|
| 1. Float  | 4. Pivot       | 7. Terminal                      | 10. Magnet      |
| 2. Shaft  | 5. Housing     | 8. O-ring                        | 11. Screw       |
| 3. Flange | 6. Reed Switch | 9. Conduit<br>Conduit/Connection | 12. Microswitch |

► The diameter and length of the connecting pipe (of a tank) are in direct proportion.

UNIT: mm

Pipe dia. (A)	45-50	50-55	55-60	60-65	65-70
Length (B) (Max.)	130	140	150	160	170

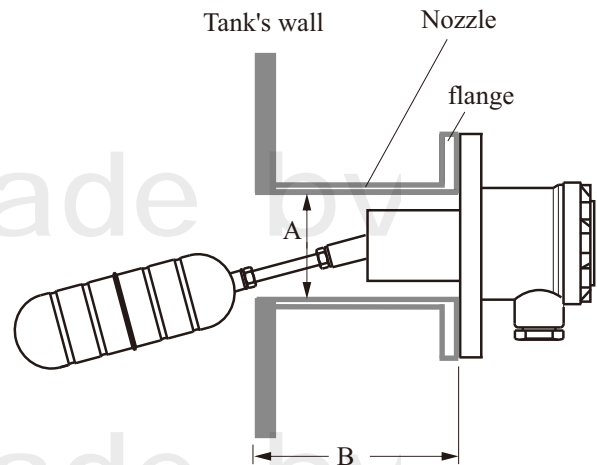

Information provided as an indication and subject to possible modification

# SPECIFICATIONS



MODEL	Operating Temp	Electrical Contact	Contact Capacity	Contact Element	Housing Spec	Applicable S.G.
MXT-833610CLO	-20°C / 100°C	SPDT(1C)	5A/250Vac	Microswitch	Aluminum Alloy IP65	0.65

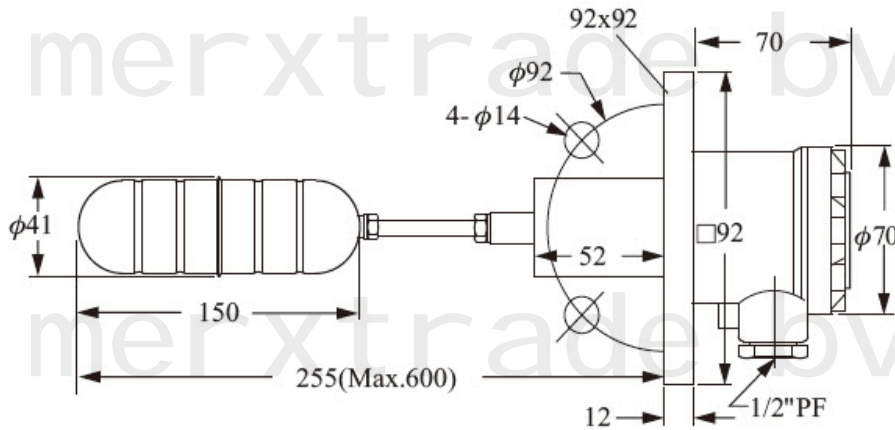

## Drill Hole

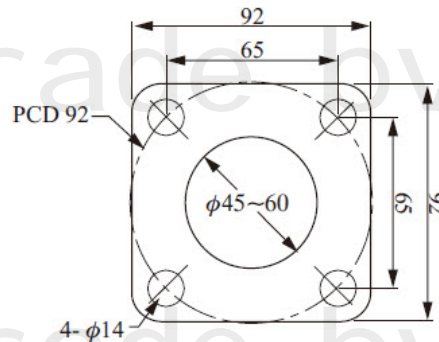

※ Above-mentioned models are approved by class societies : DNV 、 LR 、 GL 、 BV 、 ABS 。

Information provided as an indication and subject to possible modification